

PolarCool Pump Replacement

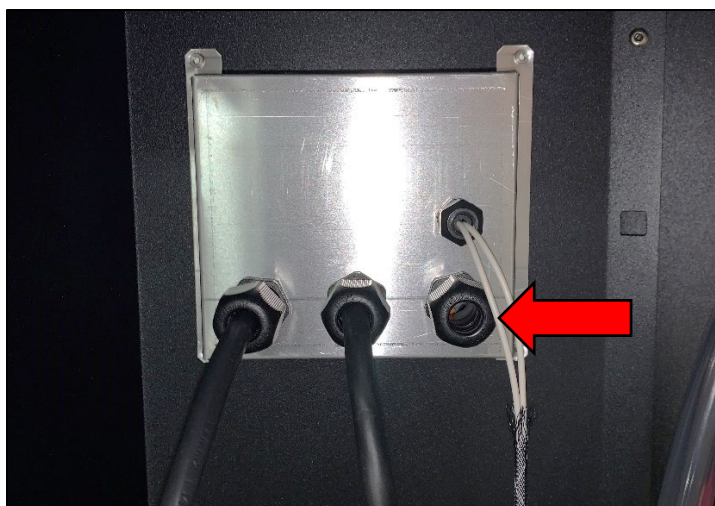

1. Turn off power to the fan and the pump, unplug the power cable, and disconnect the water supply.
2. Open the cover at the top of the fan.
3. Remove the pads by tilting them toward yourself, then lifting them out.
4. Detach the control panel by removing the four 3/32" Allen screws.
5. Place a protective cover (such as bubble wrap) between the control panel and the side of the fan.
6. Unplug the black, green, and white wires (part of the pump power cable) from the control panel.
7. Trace the pump power cable to the electronics enclosure, then loosen the strain relief there.
8. Remove the pump power cable from the strain relief and the electronics enclosure.



9. Disconnect the hose from the old pump. Set the clamp aside.
10. Cut the cable tie that holds the pump to the bracket.
11. Remove the pump.
12. Place the new pump in front of the bracket, ensuring the intake is at the bottom.
13. Secure the pump by wrapping the provided cable tie around it and through the two holes in the bracket.

14. Clamp the hose to the new pump.



15. Route the new pump power cable through the strain relief and into the electronics enclosure.
16. Plug the wires from the new pump power cable into the control panel as follows:
 - a. Plug the brown wire in place of the black wire.
 - b. Plug the blue wire in place of the white wire.
 - c. Plug the new green wire in place of the old green wire.

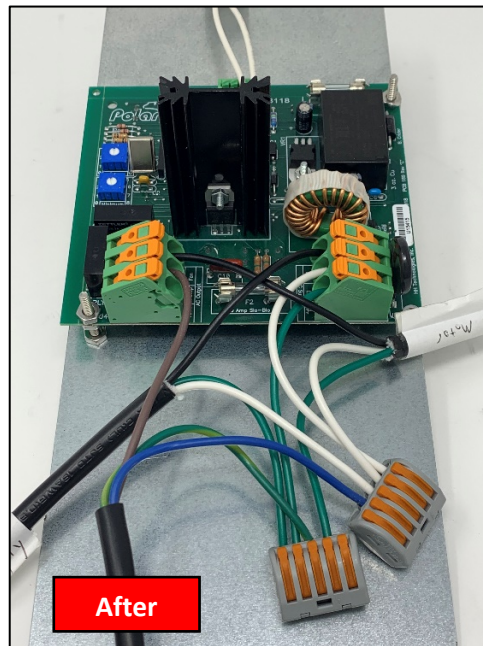

17. Tighten the strain relief.
18. Reinstall the control panel using the four 3/32" Allen screws.
19. Reinstall the pads.
20. Close the fan cover.
21. Reconnect the water supply.
22. Plug the power cable back in.
23. Run the pump for at least 15 minutes to saturate the pads with water.
24. Turn the fan on.

NOTICE: Do not run the pump without water in the reservoir. Doing so may damage the pump.

